

# GROUND FLOOR

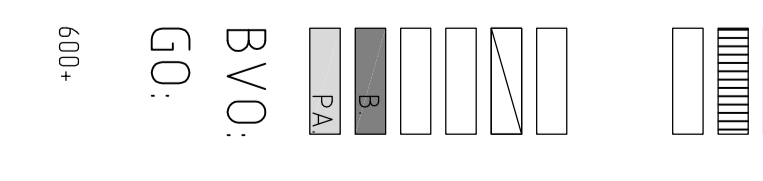
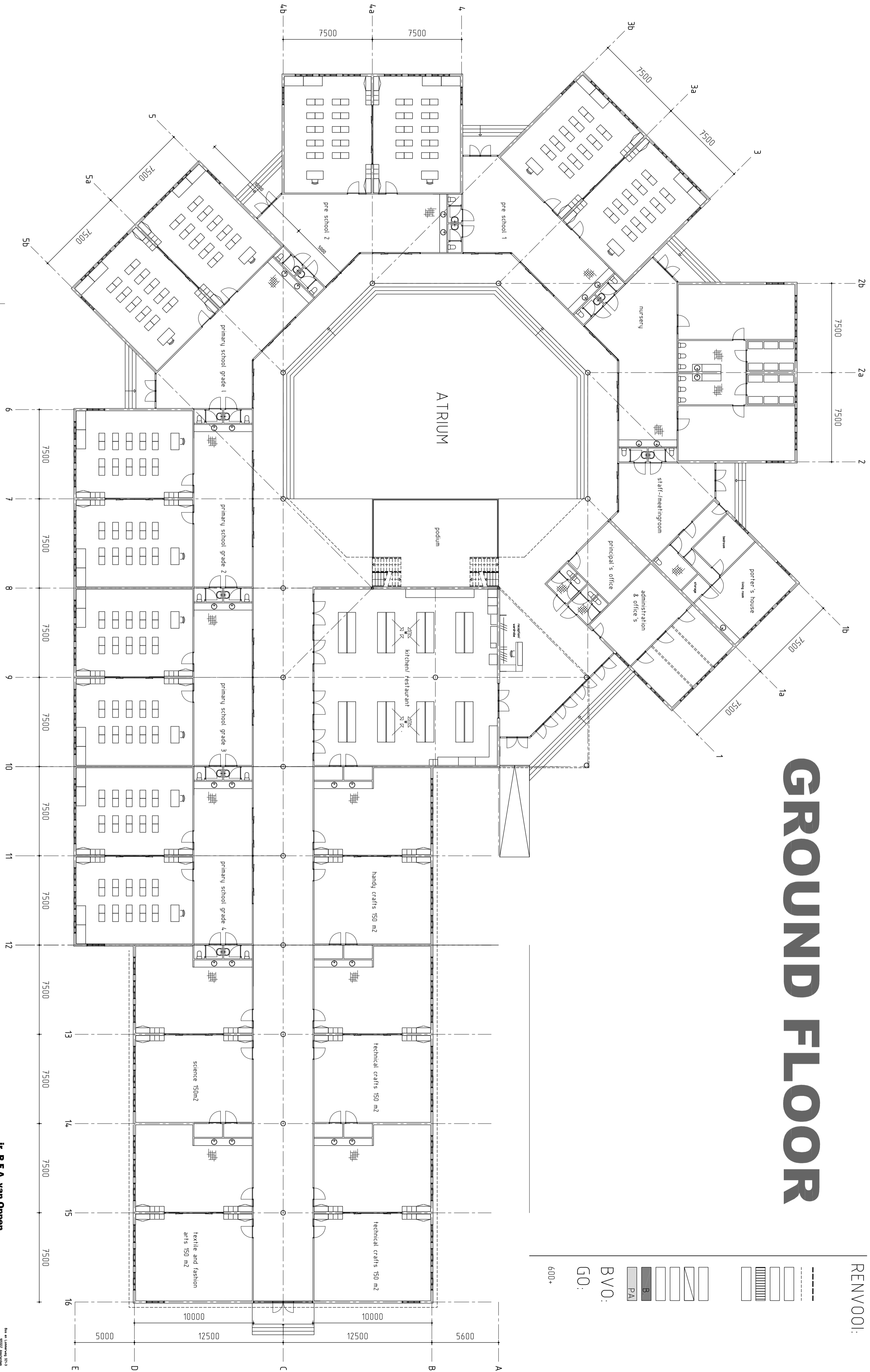

**Ir. P.F.A. van Oppen**  
 Architect  
 SAPANA SCHOOL  
 Sapana lodge  
 Ir. P.F.A. van Oppen  
 Scale 1:100  
 AT  
 PRELIMINARY  
 23 10 2009  
 032009

**NORTH ELEVATION 1:200**